

WHAT IS HAPPENING HERE?

The Part 8 Planning Procedure for Proposed Enhancements and Upgrades at Corkagh Park was advertised for public consultation in 2021 and passed by the Council in February 2022. The proposals included the following works-

- Provision of wayfinding and signage installations.
- Construction of a new 'hub zone' to include a Café building with 10 no. public toilets, kitchen, storage, serving area and internal seating; multi-use events space with a stage and hard-standing area; soft-landscaping with formal seating areas; picnic areas; amenity lawn; mounds; incidental play area; and planting.
- Removal and replacement of trees that are in poor health or pose a risk to safety.
- Upgrading of St. John's Wood Car Park to include resurfacing; improved pedestrian links and footpaths.
- Upgrading and extension of Green Isle Car Park and park entrance to include relocation and widening of existing entrance.
- Enhancements to the Fairy Woodland Trail including new play features; new seating; new pedestrian link from the lakes; retention and protection of existing mature trees.
- Upgrading of entrance and construction of a new footpath linking existing car park to the Outer Ring Road; future-proofing for EV charging points and extension of car park; and 11m high arrival beacon at Outer Ring Road Entrance.
- Provision of a new pedestrian link between the Camac Valley Camping Park and Corkagh Park.
- Enhancements to pedestrian entrance and boundary at St. John's Wood Drive.
- Proposed planting, furniture and landscape works associated with the proposed development.

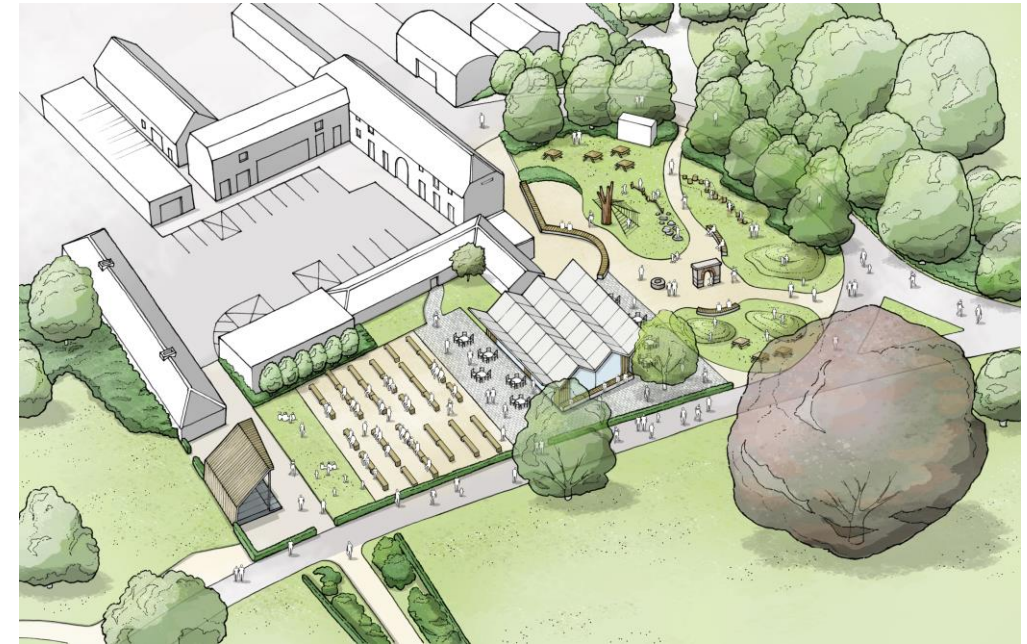

New 'hub zone' to include a Café building and a multi-use events space and stage



Upgrade and extension of Green Isle car park to include relocation and widening of existing entrance.



Enhancements to the Fairy Woodland Trail including new play features; seating; new pedestrian link from lakes; retention of existing mature trees.



Upgrade of St. John's Wood Car Park to include resurfacing; improved pedestrian links and footpaths and entrance improvements.

WHEN WILL WORK HAPPEN?

- ❑ Preliminary work started on site with the completion of tree pruning and removal in February 2023.
- ❑ Preliminary Archaeological investigations took place in April 2023. This work involved the digging of trenches in an area directly to the south of the park depot buildings and also in locations around the Green Isle Carpark.
- ❑ The main construction work will begin in the second half of 2023.

South Dublin County Council apologises for any inconvenience to the public that may arise during these works.

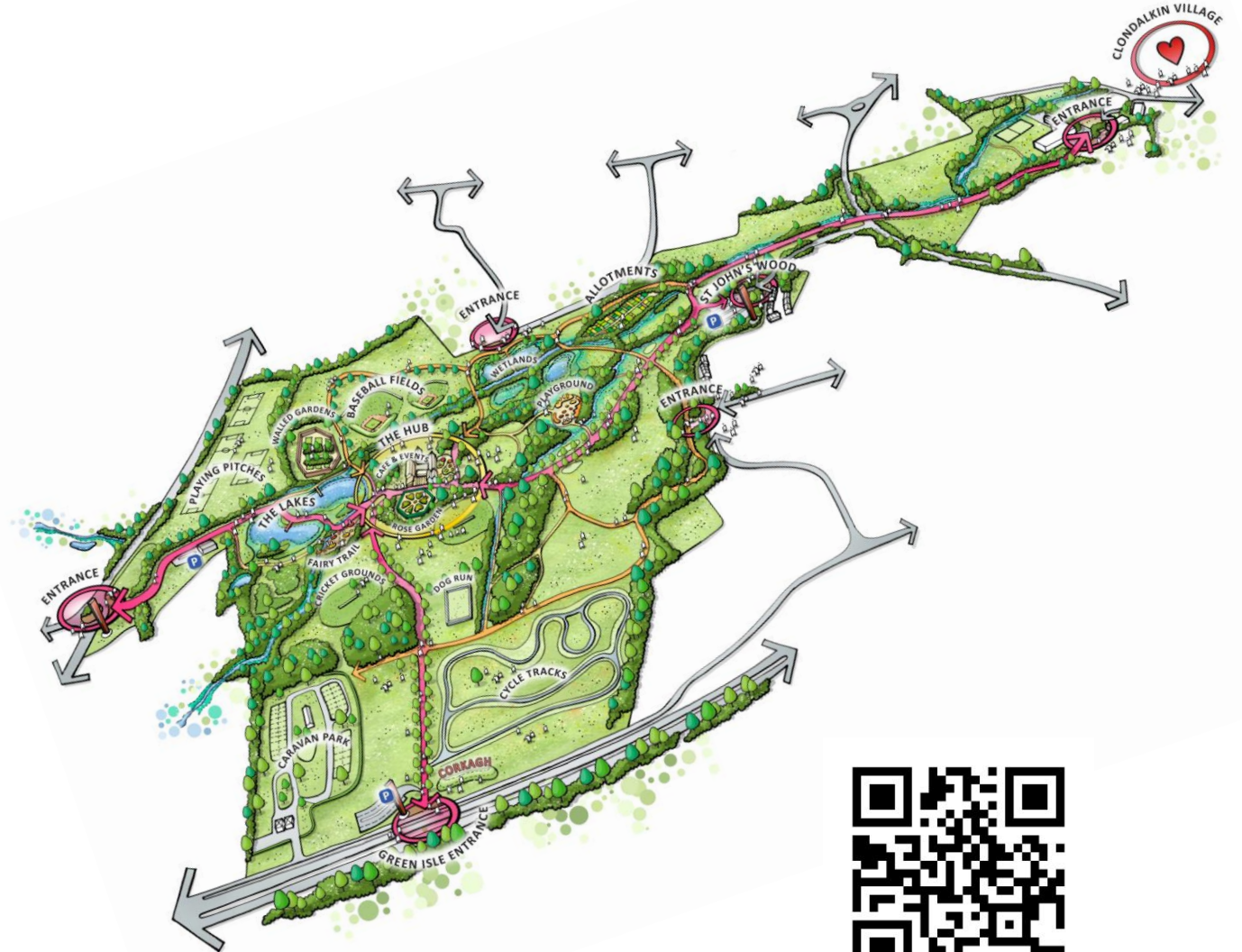

WHAT IS HAPPENING NOW?

Archaeological Investigations June/July 2023

- Work will be carried out to protect any potential archaeological heritage that may be present in the areas associated with the proposed enhancement works to the park.
- Archaeologists will strip soil from an area directly South of the depot building (location map illustrated). This work will be carried out under an archaeological licence granted by The National Monuments Service.
- The location will be cordoned off to protect park users and the area reinstated in a safe manner following investigations. South Dublin County Council apologises for any inconvenience to the public that may arise during these works.
- For more information please visit-
www.sdcc.ie/en/services/sport-and-recreation/parks/corkagh-park.html

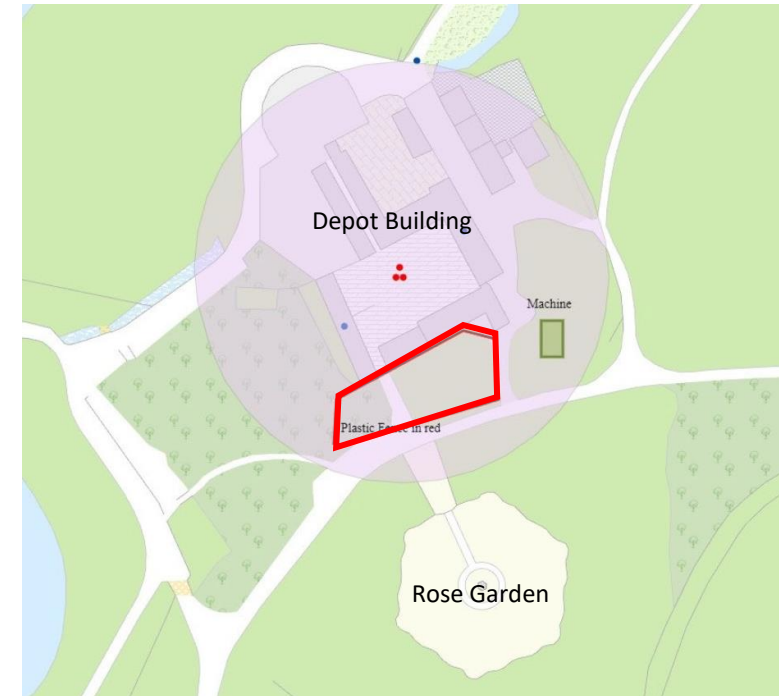

Soil will be stripped in a location south of the depot building, within the redline area illustrated.

